

1 2 3 4 5 6 7 8

DIMENSION

NO OF POS	DIM A	DIM B	DIM C	DIM D	NO OF POS	DIM A	DIM B	DIM C	DIM D
2X3=6	5.08	10.16	14.22	---	2X33=66	81.28	86.36	90.42	WX1Z
2X4=8	7.62	12.70	16.76	---	2X34=68	83.82	88.90	92.96	WX1Z
2X5=10	10.16	15.24	19.30	---	2X35=70	86.36	91.44	95.50	WX1Z
2X6=12	12.70	17.78	21.84	---	2X36=72	88.90	93.98	98.04	WX1Z
2X7=14	15.24	20.32	24.38	---	2X37=74	91.44	96.52	100.58	WX1Z
2X8=16	17.78	22.86	26.92	---	2X38=76	93.98	99.06	103.12	WX1Z
2X9=18	20.32	25.40	29.46	---	2X39=78	96.52	101.60	105.66	WX1Z
2X10=20	22.86	27.94	32.00	XY	2X40=80	99.06	104.14	108.20	WX1Z
2X11=22	25.40	30.48	34.54	XY	2X41=82	101.60	106.68	110.74	WX1Z
2X12=24	27.94	33.02	37.08	XY	2X42=84	104.14	109.22	113.28	WX1Z
2X14=28	33.02	38.10	42.16	XY	2X43=86	106.68	111.76	115.82	WX1Z
2X15=30	35.56	40.64	44.70	XY	2X44=88	109.22	114.30	118.36	WX1Z
2X16=32	38.10	43.18	47.24	XY	2X45=90	111.76	116.84	120.90	WX1Z
2X17=34	40.64	45.72	49.78	XY	2X46=92	114.30	119.38	123.44	WX1Z
2X19=38	45.72	50.80	54.86	XY	2X47=94	116.84	121.92	125.98	WX1Z
2X20=40	48.26	53.34	57.40	XY	2X48=96	119.38	124.46	128.52	WX1Z
2X21=42	50.80	55.88	59.94	XY	2X50=100	124.46	129.54	133.60	WX1Z
2X22=44	53.34	58.42	62.48	XY	2X51=102	127.00	132.08	136.14	WX1Z
2X23=46	55.88	60.96	65.02	XY	2X53=106	132.08	137.16	141.22	WX1Z
2X24=48	58.42	63.50	67.56	XY	2X54=108	134.62	139.70	143.76	WX1Z
2X25=50	60.96	66.04	70.10	XY	2X55=110	137.16	142.24	146.30	WX1Z
2X26=52	63.50	68.58	72.64	XY	2X56=112	139.70	144.78	148.84	WX1Z
2X27=54	66.04	71.12	75.18	XY	2X57=114	142.24	147.32	151.38	WX1Z
2X28=56	68.58	73.66	77.72	XY	2X58=116	144.78	149.86	153.92	WX1Z
2X29=58	71.12	76.20	80.26	XY	2X59=118	147.32	152.40	156.46	WX1Z
2X32=64	78.74	83.82	87.88	WX1Z					

PART NUMBER: CPM-XXXX1COS-XXX

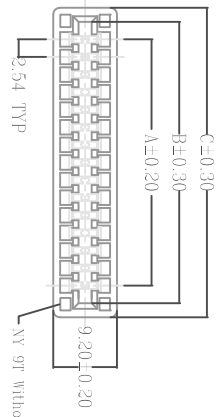
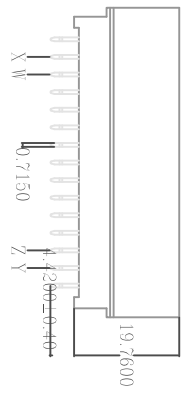
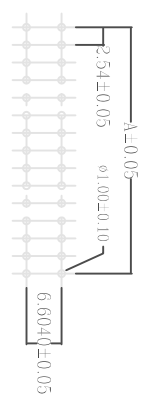
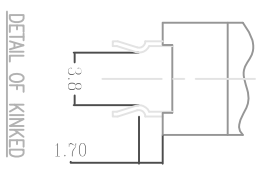
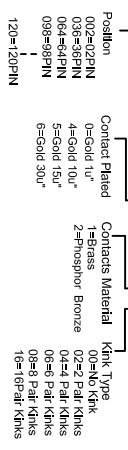

2.4700^{+0.0000}
0.060±0.20

RECOMMENDED PCB LAYOUT

ELECTRICAL
 DIELECTRIC WITHSTANDING VOLTAGE: 1,000 VAC
 RMS.
 CURRENT RATING: 3 AMP.
 INSULATION RESISTANCE: 5,000 MEG. OHMS MIN.
 AT 500. VDC.
 CONTACT RESISTANCE: 20 MILLI OHMS MAX.

MATERIAL
 INSULATOR: PBT GLASS-REINFORCED
 THERMOPLASTIC, UL94V-0 RATED.
 CONTACT: COPPER ALLOY.
 PLATING: CONTACT AREA- SELECTIVE GOLD OVER
 NICKEL. SOLDER AREA- TIN OR TIN/LEAD OVER
 NICKEL.

MECHANICAL
 INSERTION FORCE: 340 GRAMS MAX PER CONTACT
 PAIR.
 WITHDRAWAL FORCE: 28 GRAMS MIN PER CONTACT
 PAIR.

ENVIRONMENTAL
 TEMPERATURE RANGE: -55°C TO +85°C.

ROHS

A		B		C		D		E		F	
REV.	DESCRIPTION	RELEASE	DATE								
		2009.8.27									
TOLERANCES		CARDEDGE SLOT, 2.54mm PITCH									
X.X ±0.3											
X.XX ±0.2											
X.XXX ±0.1											
Angle ±5°											
13001		UNIT	SCALE	SIZE	DRAW NO.	APPROVED BY	REV.				
		MM	NONE	A4	P-008		A				
		DRAWN BY <i>Singela</i>		CHECKED BY <i>Paive</i>		APPROVED BY <i>Benson</i>					